

# Edge7

High Performance Invisible Loudspeaker

DATASHEET V1.2

amina

## Product Description

A new revolutionary design for invisible loudspeaker technology, the Amina Edge7 offers smooth low frequency extension with increased power handling and sensitivity, resulting in a dynamic and engaging listening experience that has never before been heard from an invisible loudspeaker. Building on the award-winning Evolution Series design, the Edge7 incorporates OptiDamping, OptiDrive and Reduced-Resonance Exciter technology built into a plaster up-to design. The speaker uses a high quality fire-resistant panel material which allows for seamless integration into plasterboard walls and ceilings without the need for a full wet skim, all in the easy to install, lightweight form-factor that Amina is known for.

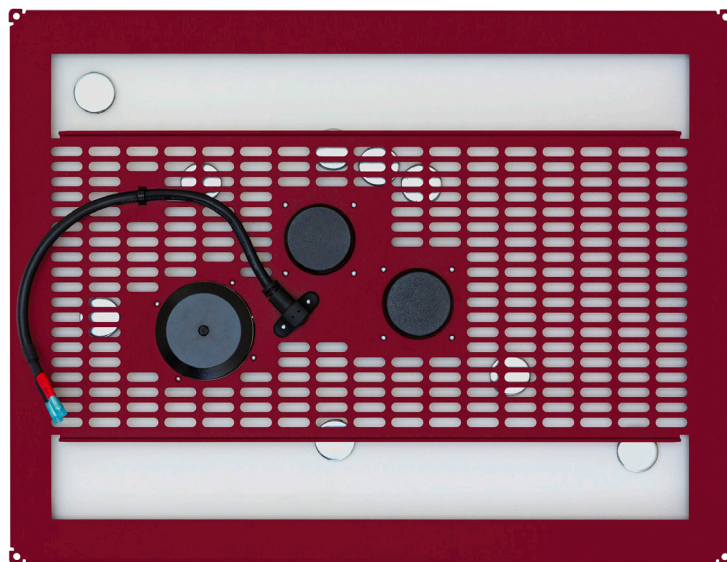
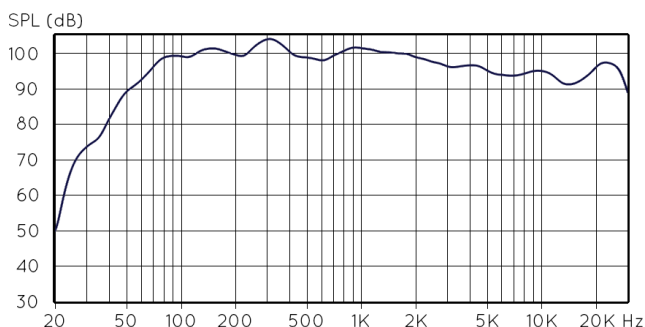

## Example Applications

High-power residential/commercial distributed audio solutions and multi-channel surround sound systems. Designed for dryline installation or retrofit into fully skimmed walls/ceilings. Not suitable for solid-wall installation.

## Compatible Accessories

BackboxCV345, Firehood345, Mounting Blocks, Shim Kits, APUi70C, APU-RS8iC, APU-RS16iC, ALF120.

## Specifications

|  |  |
|--|--|
| Nominal impedance  | 4 Ohms   |
| Power handling (100 hour continuous/peak)                  | 75W/150W   |
| Sensitivity  | 93dB 1m/2.83Vrms   |
| Frequency response   | 45Hz - 20kHz ( $\pm 6$ dB) mounted in Backbox CV345                                    |
| Electrical connection                                      | Blue butt-splice crimp terminals (14-16 AWG)   |
| Dimensions   | 450mm x 345mm x 31mm (17 <sup>3/4</sup> " x 13 <sup>5/8</sup> " x 1 <sup>1/4</sup> " ) |
| Product weight   | 1.78Kg (3lbs 15oz)   |
| Fixing requirements  | BackboxCV345 (mounting blocks available on request)                                    |
| In-line protection unit                                    | APUi70C, APU-RS8iC or APU-RS16iC   |
| Manufacturer limited warranty for residential applications | 10 years   |

## Edge7

### Amina Technologies Limited

Cirrus House, Glebe Road, Huntingdon, Cambridgeshire, PE29 7DL, England  
T: +44 (0) 1480 354390 | E: info@aminasound.com | W: www.aminasound.com

# Edge7

High Performance Invisible Loudspeaker

DATASHEET V1.2

*amina*

## Panel Detail

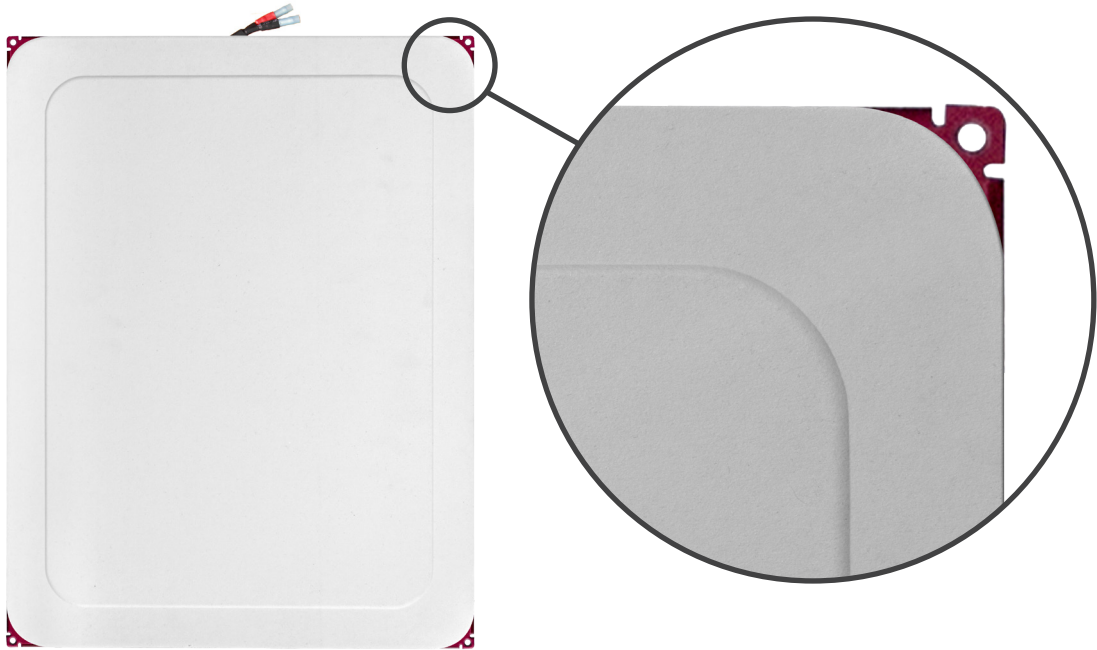

## Installation Section Detail - Retrofit Wet Skim

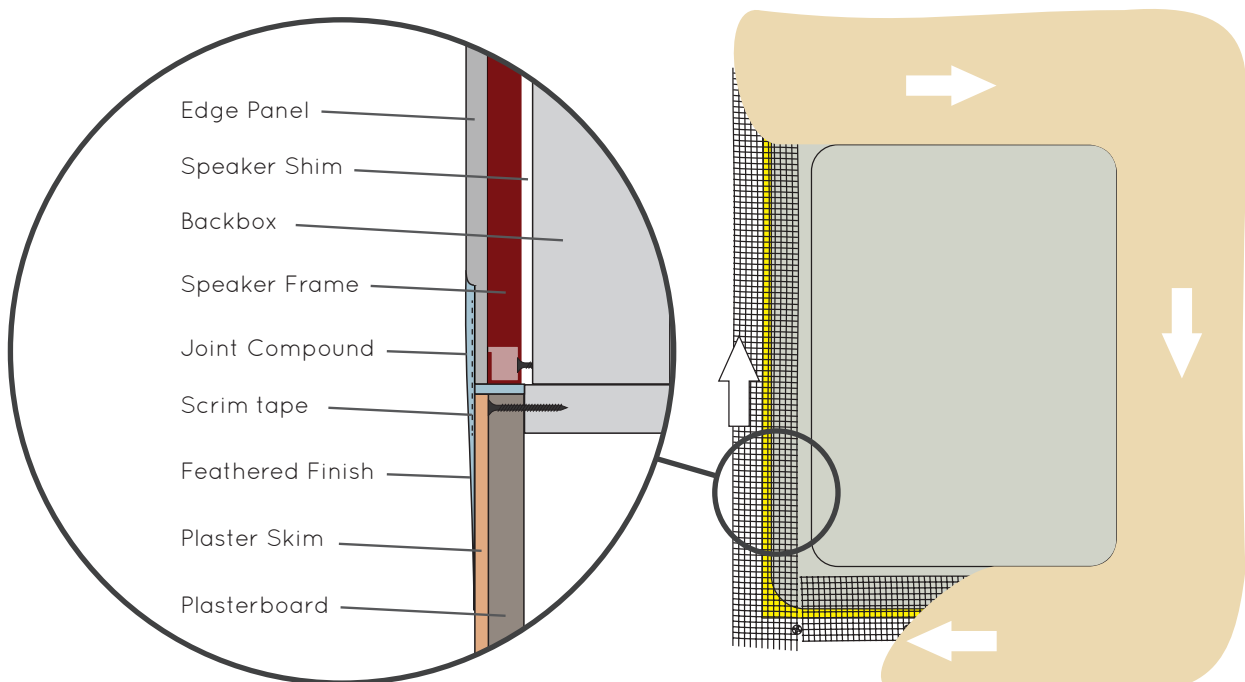

**Amina Technologies Limited**

Cirrus House, Glebe Road, Huntingdon, Cambridgeshire, PE29 7DL, England  
T: +44 (0) 1480 354390 | E: inspired@aminasound.com | W: www.aminasound.com